

SPECIFICATIONS

ELECTRICAL

RESISTANCE RANGE ----- SEE CHART
 RESISTANCE TOLERANCE ----- ±5%
 LINEARITY (INDEPENDENT) ----- SEE TABLE
 END RESISTANCE ----- 1 OHM OR 1%
 ELECTRICAL NOISE (ENR) ----- 100 OHM MAX.
 RESOLUTION ----- SEE CHART
 INSULATION RESISTANCE ----- 100 MEGOHMS MIN. AT 500 VDC
 DIELECTRIC STRENGTH ----- 500 VAC
 POWER RATING ----- SEE TABLE

MECHANICAL

STOP STRENGTH ----- 20 LBS.
 WEIGHT ----- SEE TABLE

ENVIRONMENTAL

OPERATING TEMPERATURE ----- -30°C TD + 105°C
 TEMPERATURE COEFFICIENT ----- SEE CHART
 VIBRATION ----- 10HZ TD 2000HZ 10G
 SHOCK ----- 30G 11MS
 MOISTURE RESISTANCE ----- 40°C 95%RH 120 HRS.

MATERIALS

HOUSING ----- ANODIZED ALUMINUM
 SHAFT ----- STAINLESS STEEL
 BUSHING ----- ANODIZED ALUMINUM
 RESISTANCE ELEMENT ----- WIREWOUND

OPTIONAL FEATURES

SHAFT MODIFICATIONS
 SPECIAL STROKES
 OIL FILLED

RESOLUTION CHART %

| RESISTANCE DASH NO. | 15 | 20 | 50 | 100 | 200 | 500 | 1K | 2K | 5K | 10K | 20K | 40K |
|---------------------|-----|-----|-----|-----|-----|-----|-----|-----|-----|-----|-----|-----|
| -30 | .72 | .59 | .42 | .46 | .36 | .27 | .22 | .17 | .12 | .10 | | |
| -50 | | | .29 | .24 | .26 | .19 | .16 | .12 | .09 | .07 | | |
| -100 | | | .19 | .14 | .12 | .12 | .10 | .08 | .06 | .04 | .04 | .03 |

| DASH NO. | MECHANICAL STROKE ±.060 | ELECTRICAL STROKE ±.040 | LINEARITY INDEPENDENT | A ±.040 | B ±.040 | APPROX. WEIGHT | POWER RATING |
|----------|-------------------------|-------------------------|-----------------------|---------|---------|----------------|--------------|
| -30 | 1.260 | 1.181 | ± 1.0% | 3.346 | 5.708 | 1.1 OZ | 0.5 W |
| -50 | 2.047 | 1.968 | ± 0.7% | 4.134 | 7.283 | 1.3 OZ | 0.75 W |
| -100 | 4.015 | 3.937 | ± 0.5% | 6.102 | 11.220 | 1.8 OZ | 1 W |

DIMENSION TABLE

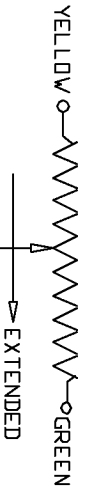

SCHEMATIC

MODEL NO'S.

LWR10A -(STROKE)-(RES.) (A)

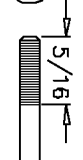

SHAFT STYLES

#4-40 THREAD

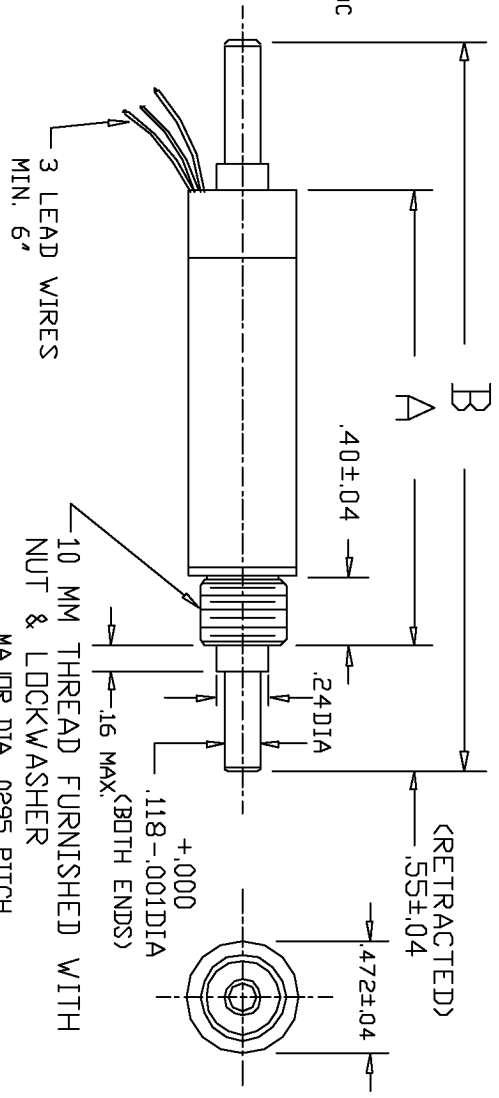

| REV. | BY | DATE | PART NO. |
|------|----|----------|----------|
| E | AT | 08-09 01 | LWR10 |

ADDED SHAFT OPTIONS AND STYLES

TOLERANCES

XX = +/- .010" FRACT. = +/- 1/64"
 XXX = +/- .005" ANGLES = +/- 1/2°

ALL SPECIFICATIONS SUBJECT TO CHANGE WITHOUT NOTICE.

THIS DOCUMENT CONTAINS PROPRIETARY DATA OF POLARIS INDUSTRIAL ENTERPRISES, INC. NO DISCLOSURE, REPRODUCTION, OR USE OF ANY PART THERE OF MAY BE MADE EXCEPT BY WRITTEN PERMISSION.

**LINEAR MOTION
 POTENTIOMETER**

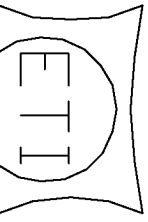

CARLSBAD, CALIFORNIA

PART NO. LWR10