

REV.	BY	DATE	PART NO.	EUP1900/1950

ELECTRICAL CHARACTERISTICS.

RESISTANCE ELEMENT ----- CONDUCTIVE PLASTIC
 RESISTANCE RANGE(OHM) ----- 1K,5K,10K(OTHER VALUES UPTO 100K)
 RESISTANCE TOLERANCE ----- ±20%
 BEST POSSIBLE RESISTANCE TOLERANCE ----- ±10%
 LINEARITY INDEPENDENT ----- ±2%
 BEST POSSIBLE LINEARITY INDEPENDENT ----- ±1%
 ELECTRICAL ANGLE ----- 340°±4'
 RESOLUTION ----- ESSENTIALLY INFINITE
 TEMPERATURE COEFFICIENT ----- ±400 PPM/°C
 POWER RATING (+70°C) ----- 1.0 WATT
 INSULATION RESISTANCE ----- 1000MEGOHMS @ 500VDC MIN.
 DIELECTRIC STRENGTH ----- 750 VAC
 MAXIMAL WIPER CURRENT ----- 1 mA
 END VOLTAGE ----- <0.5% MAX.

MECHANICAL CHARACTERISTICS.

ROTATION EUP1900 ----- 360° CONTINUOUS
 ROTATION EUP1950 ----- 340° ±5° WITH ENDSTOPS
 STOP STRENGTH (EUP1950) ----- 50 OZ-IN
 BEARING TYPE ----- SLEEVE
 TORQUE STARTING ----- 0.30 OZ.IN.
 TORQUE RUNNING ----- 0.25 OZ. IN.

ENVIRONMENTAL CHARACTERISTICS.

ROTATIONAL LIFE ----- 2 MILLION TURNS MIN.
 OPERATING TEMPERATURE ----- -55°C TO +105°C

MATERIALS

HOUSING ----- ALUMINIUM CHROMIC ANODYZED
 SHAFT ----- STAINLESS STEEL
 TERMINALS ----- GOLD PLATED BRASS
 MOUNTING HARDWARE ----- LOCKWASHER,NUT-BRASS,NICKLE-PLATED
 BUSHINGS ----- BRASS

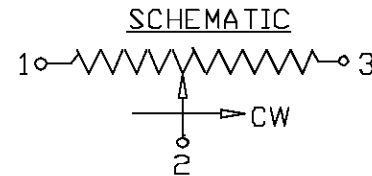
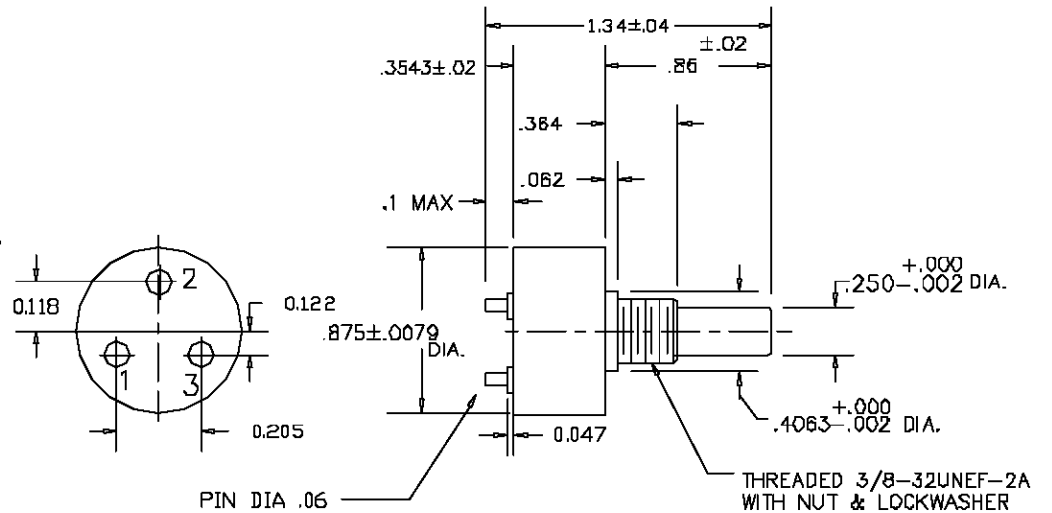

CONDUCTIVE PLASTIC ELEMENT

SCALE	NONE
DATE:	5-01-03
BY	AT
APPRV'D	

THIS DOCUMENT CONTAINS PROPRIETARY DATA OF POLARIS INDUSTRIAL ENTERPRISES,INC. NO DISCLOSURE, REPRODUCTION, OR USE OF ANY PART THERE OF MAY BE MADE EXCEPT BY WRITTEN PERMISSION.

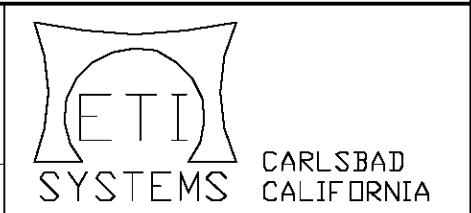

TOLERANCES
 XX = +/- .010" FRACT. = +/- 1/64"
 XXX= +/- .005" ANGLES = +/- 1/2°
 ALL SPECIFICATIONS SUBJECT TO CHANGE WITHOUT NOTICE.

CODE IDENT:
19477

TITLE
SINGLE TURN
POTENTIOMETER

PART NO.
EUP1900/1950